

Model **8901B Axion** Eye/Face Wash and Body Spray

No.2080191/3

NOTE TO INSTALLER: please leave this information with the maintenance department.

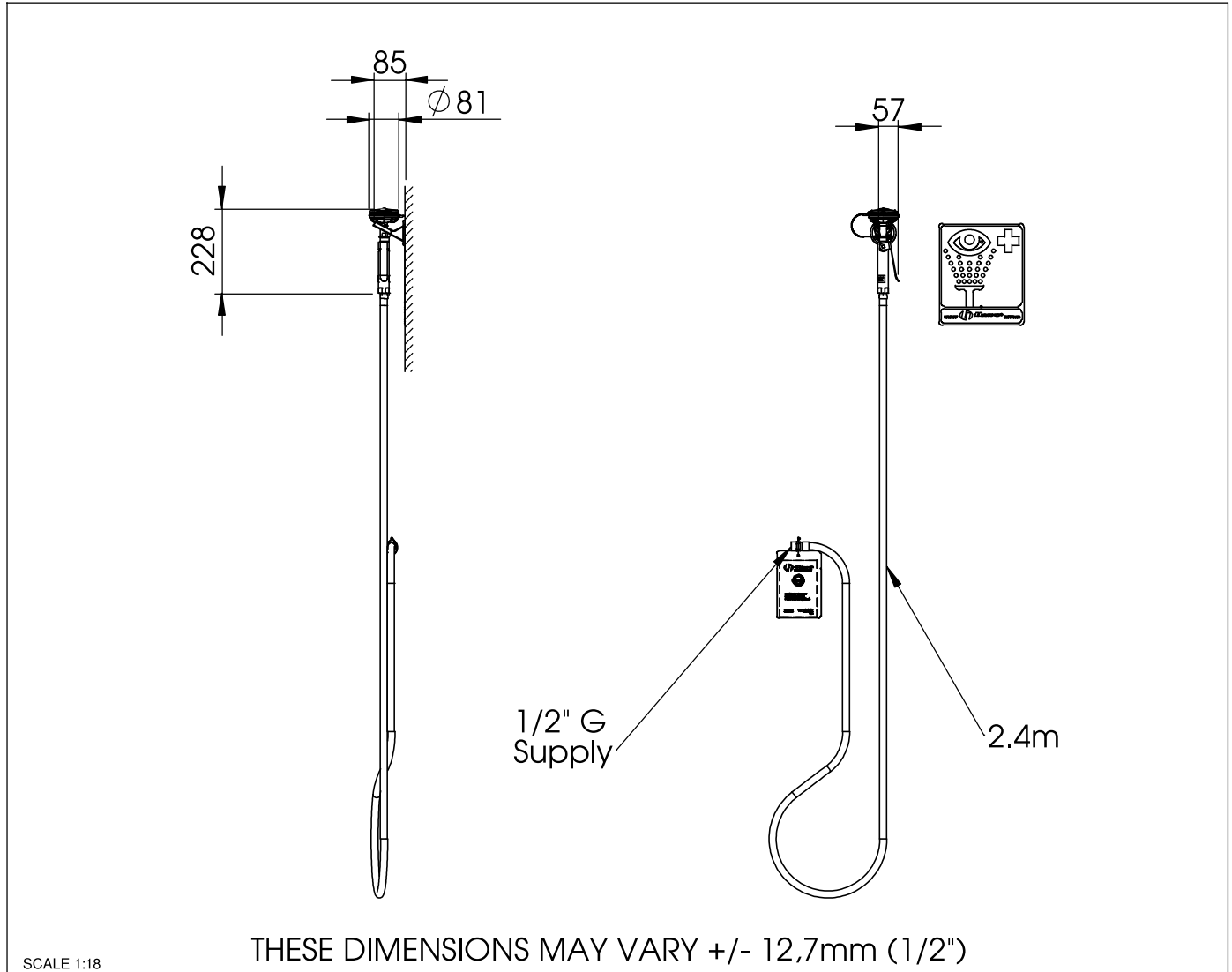

Free access to the eye/facewash & body spray 8901B Axion must be guaranteed at all times.
 The operator is responsible for the observance of this requirement.



Model **8901B Axion** **Eye/Face Wash and Body Spray** No.2080191/3

Shower location: The eye/facewash & body spray 8901B Axion must be installed in the vicinity of potential danger zones. It must be highly visible and easily accessible.

Connection conduit: You are recommended to use a 1/2" G conduit, capable of withstanding pressures of 2 - 6BAR (30 - 90PSI). The use of an inlet filter designed to prevent the entry of suspended particles and other impurities is also recommended.

Water quality: Eye/facewash & body spray require a supply of drinking water conforming to European standards or their equivalents in other countries.

Water temperature: The required water temperature should be determined by the user. The accepted ideal range is 15 - 35 °C / 60 - 95 °F (but please ensure conformity with local regulations).

Volum flow: A minimum flow rate of 6 litres / 1,6 US gallons per minute must be maintained. The eye/facewash & body spray must be capable of delivering this amount of water for at least 15 minutes.

Connection to plumbing system: The inlet consists of a 1/2" G male-threaded conduit.

Regular inspection:

The eye/facewash & body spray 8901B Axion should be inspected at weekly intervals.
The inspection tag should be dated and signed after each check.

TROUBLESHOOTING	
Problem	Repair-checklist
1. No flow	Check the main shutoff valve.
2. Insufficient flow of water	<ol style="list-style-type: none">1. Check the line pressure. This should be at least 2BAR / 30PSI (dynamic).2. Blocked flow, possibly due to the conduit not being correctly flushed out. Dismantle the spray element, and clean the rubber flow-regulator.

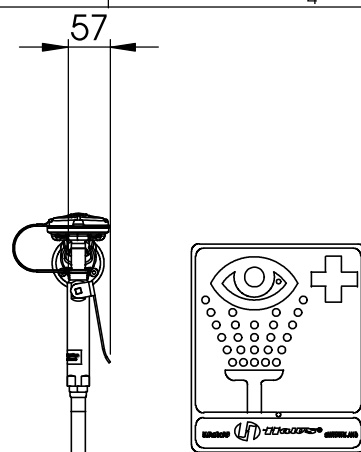
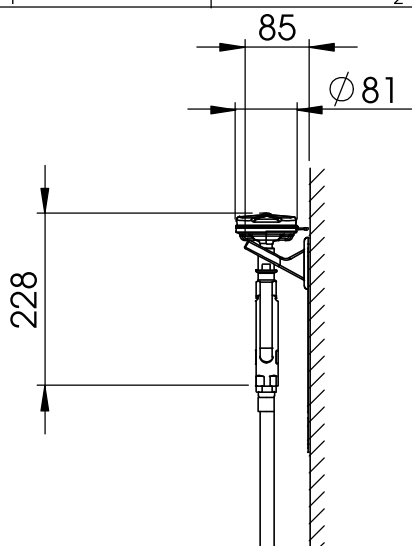

1/2" G
Supply

2.4m

Weight: 1,8kg (4lbs)

THESE DIMENSIONS MAY VARY +/- 12,7mm (1/2")

DATA SHEET



T +41 (0)34 420 60 00
F +41 (0)34 420 60 01

BACHWEG 3
CH3401 BURGDORF
SWITZERLAND

www.haws.ch
info@haws.ch

TITLE

8901B Axion
Eye/Face Wash and Body Spray

MATERIAL

SIZE PART NO.

A4 2080191/3

REV.

SCALE 1:10



SHEET 3 OF 4

ZONE	REV	DESCRIPTION	ECN	DATE	BY
REVISIONS					
THIS DOCUMENT AND THE DATA DISCLOSED HEREIN OR HEREWITH IS NOT TO BE REPRODUCED, USED, OR DISCLOSED IN WHOLE OR IN PART TO ANYONE WITHOUT THE PERMISSION OF HAWS CORPORATION.					

APPROVALS	DATE
DRAWN Jeannine Ruf	03.03.2011
CHECKED Jeannine Ruf	03.03.2011
REVISED	12.10.2011
DRAW-NO.	
ECN NO.	

PARTS BREAKDOWN

ITEM	PART NU.	DESCRIPTION
1	SP65/1	Axion eye/face wash head
2	SP247	Valve assembly
3	SP140	Hose assembly
4	SP175	Eye wash sign
5	SP170	Test tag
6	SP133	Wall bracket , plastic
7	SP37.6	Flow control

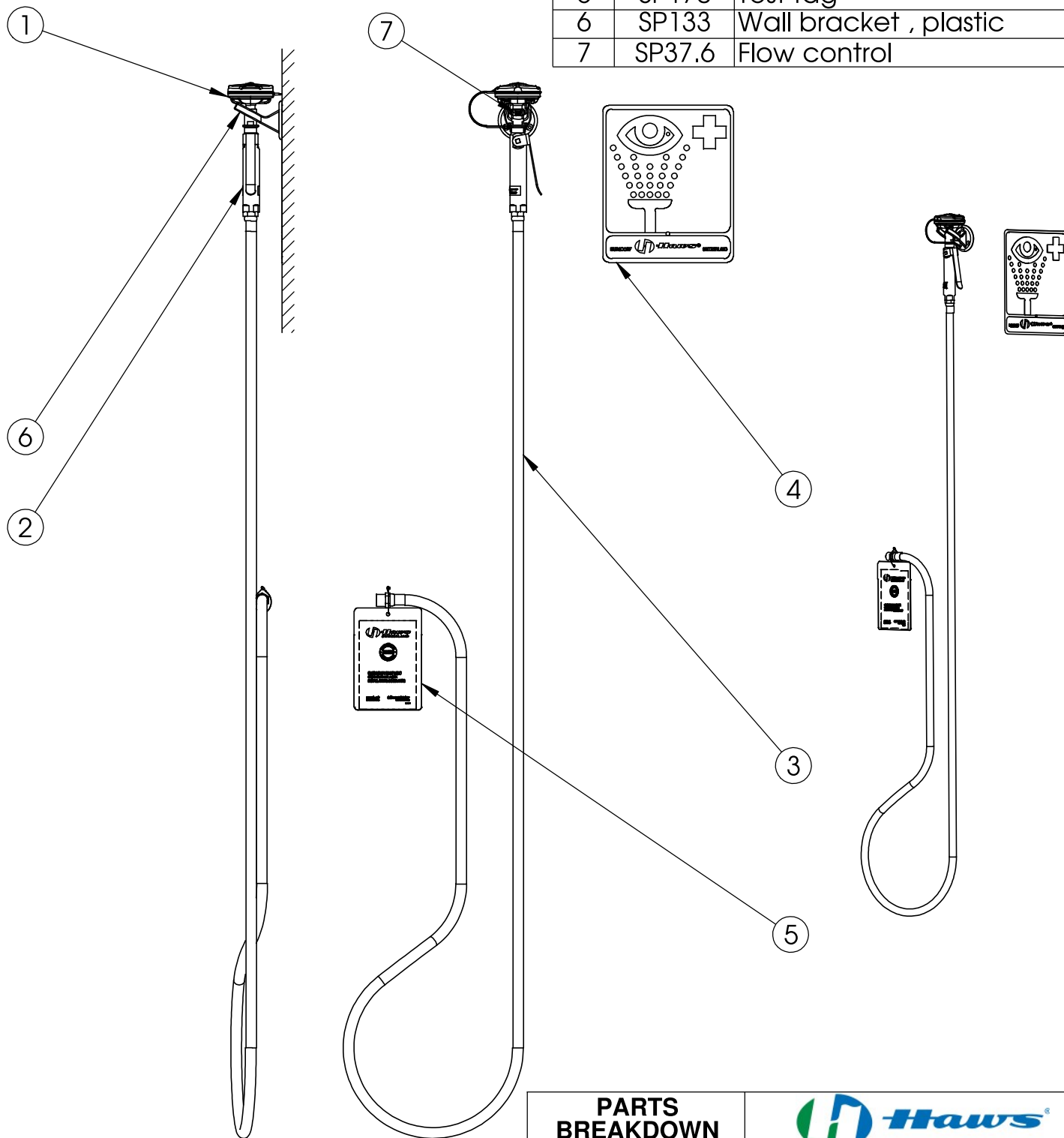

PARTS BREAKDOWN

WHEN ORDERING PARTS PLEASE SPECIFY YOUR MODEL NUMBER

APPROVALS	DATE
DRAWN Jeannine Ruf	03.03.2011
CHECKED Jeannine Ruf	03.03.2011
REVISED	12.10.2011

DRAW-NO.

ECN NO.



T +41 (0)34 420 60 00
F +41 (0)34 420 60 01

BACHWEG 3
CH3401 BURGENDORF
SWITZERLAND

www.haws.ch
info@haws.ch

TITLE

8901B Axion
Eye/Face Wash and Body Spray

MATERIAL

SIZE PART NO.

A4 2080191/3

REV.

SCALE 1:10



SHEET 4 OF 4

ZONE	REV	DESCRIPTION	ECN	DATE	BY
------	-----	-------------	-----	------	----

REVISIONS

THIS DOCUMENT AND THE DATA DISCLOSED HEREIN OR HEREWITH IS NOT TO BE REPRODUCED, USED, OR DISCLOSED IN WHOLE OR IN PART TO ANYONE WITHOUT THE PERMISSION OF HAWS CORPORATION.